

**GENERAL NOTES:**

1. REQUEST FOR A VARIANCE FROM CLEVE. HTS. FOR PROPERTY SET BACK CODE
  - A. LOCATION IN BACKYARD IS COMPROMISED DUE TO BACKYARD FLOODING EVERY SPRING
  - B. BACKYARD LOCATION COMPROMISES USAGE OF BACKYARD FOR SOCIAL PURPOSES LIKE COOKOUTS WITH FAMILY AND FRIENDS
  - C. COST OF INSTALLATION BASED ON EXTREMELY LONG RUN OF LARGE DIAMETER GAS PIPE AND NEED TO CIRCUMVENT FINISHED BASEMENT.
  - D. NEED TO PLACE GAS PIPE BELOW GRADE FROM HOUSE TO GENERATOR
2. REASONS TO APPROVE REQUEST:
  - A. PROXIMITY TO HOUSE AND PROXIMITY TO GAS METER FOR ECONOMY OF INSTALLATION. AS PROPOSED NO NEED TO EXCAVATE FOR SHORTER GAS PIPE RUN.
  - B. ACCESS TO BUILT IN 120 V OUTLET WITHIN GENERATOR FOR SIDE AND FRONT YARD USAGE AND FOR EMERGENCY SITUATIONS.

**A SITE PLAN**  
SCALE 1" = 20'-0"

**KUTASH DESIGN STUDIO**

UNINCORPORATED  
1804 Cadwell Avenue Cleveland Heights, Ohio 44118 ▲  
Phone/Fax 216 371 0261 Cell 216 225 2460

**A**  
**1**

**S. KUTASH GENERATOR** Date  
**3044 SOMERTON ROAD** May 2020  
**CLEVELAND HTS., OHIO 44118**

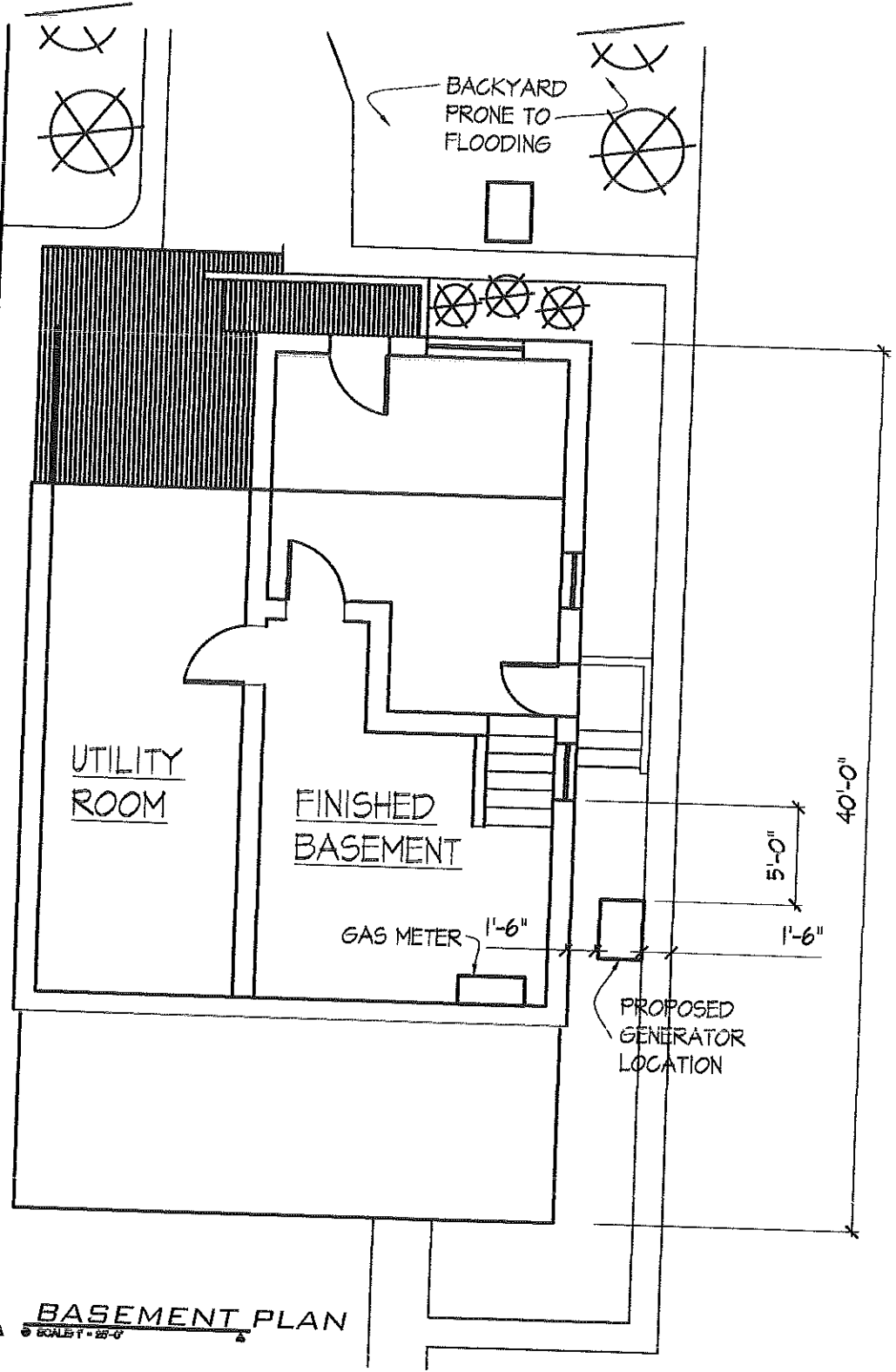

**A** BASEMENT PLAN  
SCALE: 1/8" = 1'-0"

**KUTASH DESIGN STUDIO**

UNINCORPORATED

1804 Cadwell Avenue Cleveland Heights, Ohio 44118  
 Phone/Fax 216 371 0261 Cell 216 225 2460

**A**  
**1**

**S. KUTASH GENERATOR**  
 3044 SOMERTON ROAD  
 CLEVELAND HTS., OHIO 44118

Date  
 May 2020

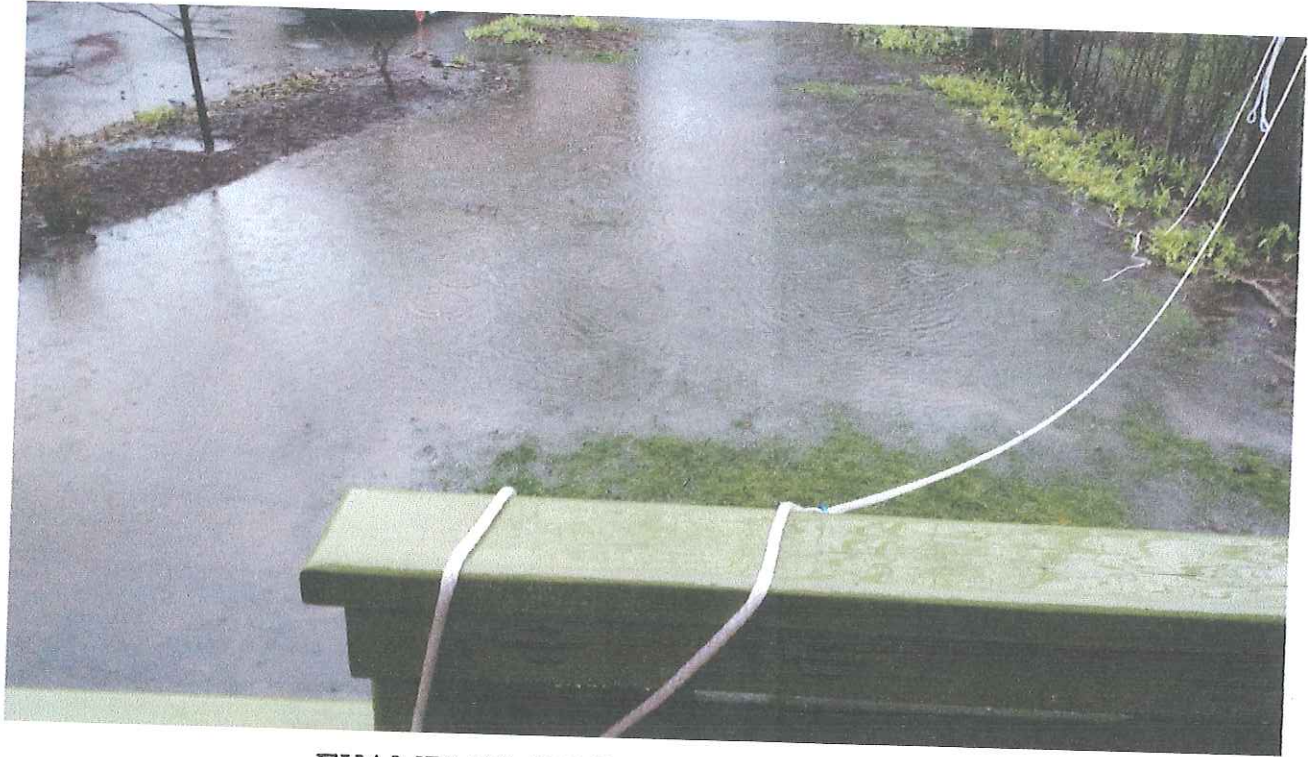

EXAMPLES OF FLOODING IN BACK-  
YARD AT GENERATOR LOCATION



WEST ELEVATION: PROPOSED LOCATION OF NEW  
GENERATOR WITH DIRECT ACCESS TO GAS METER